

Clip-on Safety Warning Signs

FOR YOUR TRAFFIC CONES AND DELINEATORS



Actual size: 12-3/4" x 10-1/2" Patented

FITS LIKE A PAPER CLIP EASY CLIP-ON SIGN



TO REMOVE
Tilt sign sideways and pull up. Keep both feet on base of cone

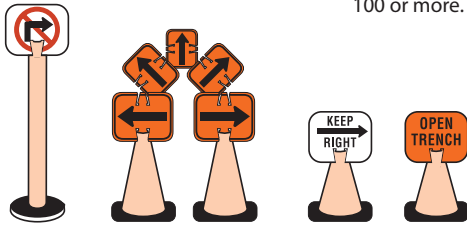

Traffic cones, delineators, and barrels only alert people, they do NOT give directions. By using the SAFETY signs with your present cones and delineators, you now give FAST and simple directions at a quick glance. This makes a safer work area and a more effective flow of traffic.

The SAFETY sign program has a proven track record, over 2,800 cities and counties are now using the SAFETY signs and are pleased with the end results. Good directions can save lives.

- Easy to install
- Reflectorized available
- Firm Grip-Locks on Traffic Cone
- Super strength durable "ABS" Plastic
- Fits any standard traffic cone or delineator
- Blank signs available
- Helps prevent drivers from hitting cones
- Special signs, made to order 100 or more.

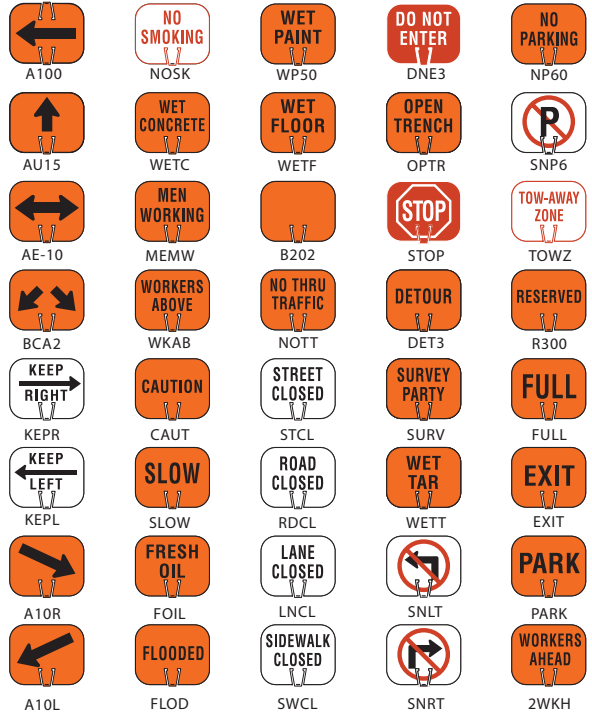

REFLECTORIZED AVAILABLE FOR ALL SIGNS

Snap-on Safety Traffic Signs

Developed as a result of research by the Federal Highway Administration

SNAP-ON TRAFFIC SIGNS attach to cones, barrels and delineation devices to give additional standard warnings and directions creating SAFER TRAFFIC CONTROL in the work zone.

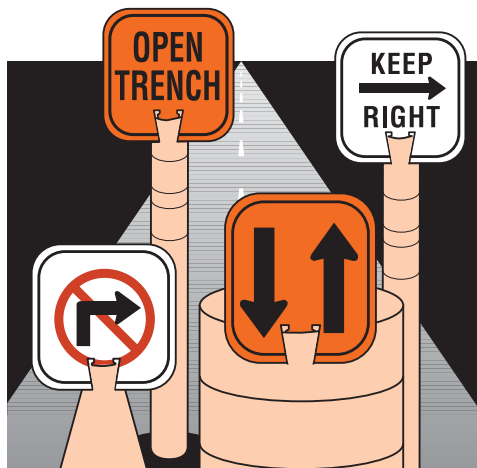

- Fast, simple installation
- Safe "ABS" Plastic with UV
- All standard messages
- Firm Grip, locks in place
- Other legends available
- Signs shown are 12"x13-3/4"
- Used by over 2,000 cities and utility companies
- Non-reflectorized available for all signs

FITS LIKE A PAPER CLIP



EASY CLIP-ON SIGN

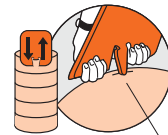

To insert into drum, cut a 2-1/2" slit here.



Patented

